

milestone  
**CITADEL**  
THE ELITE BUSINESS HUB

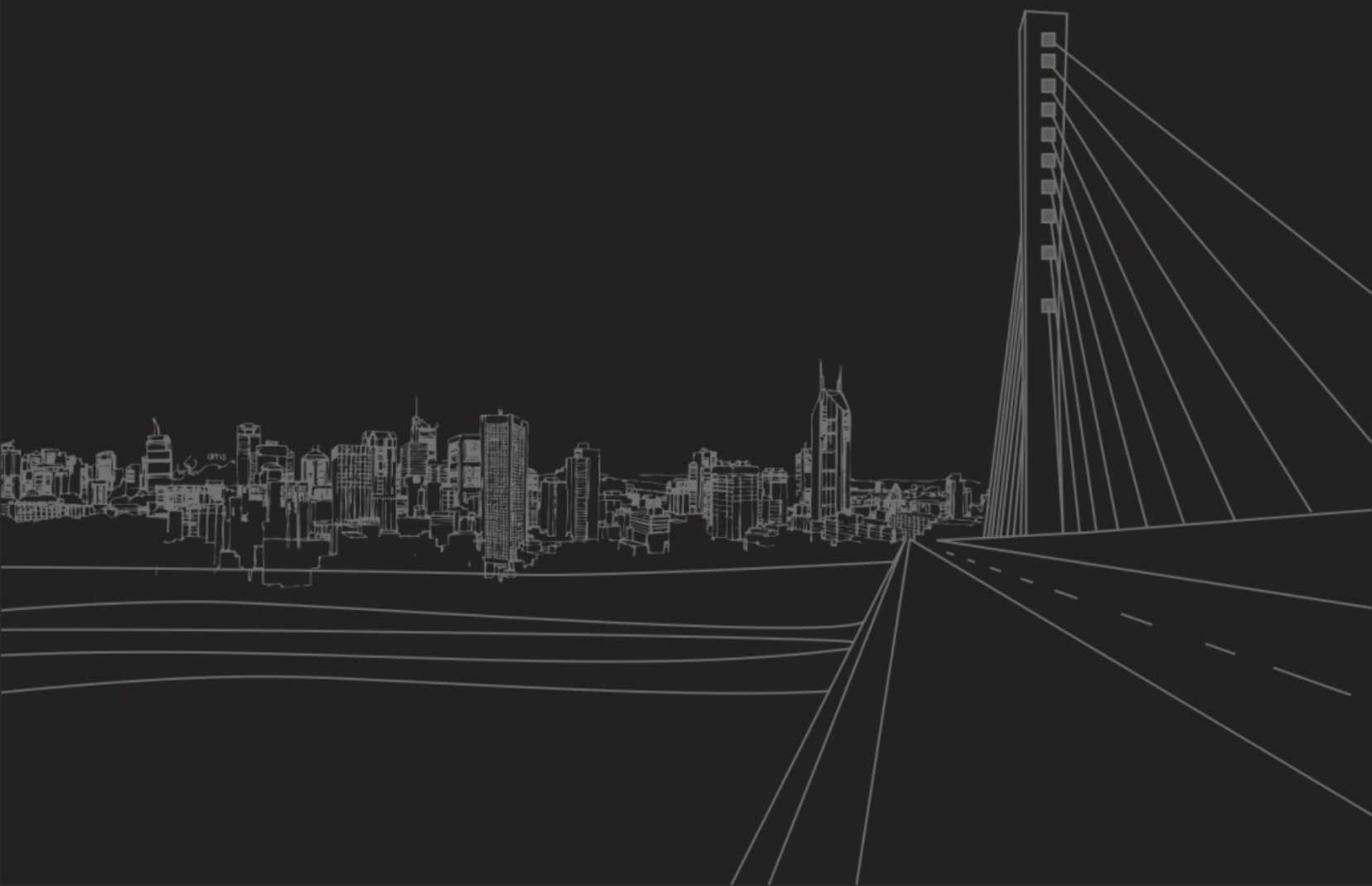

# THE LANDMARK THAT SUITS YOUR IDENTITY

---

This is a place where business will thrive,  
where inspiration is outside every window  
and where each detail has been designed  
to help businesses deliver success.





# REDEFINE YOUR BUSINESS CLASS

---

Reflecting an excellent combination of international, national and local brands across a range of general, specialised and niche product lines.



3

Level  
Basement  
Parking



8

Luxurious  
Showrooms &  
Shops



99

Professional  
Offices  
Space



# THE NEW SUN RISING ON BUSINESS HORIZON OF SURAT

---

Milestone CITADEL has an edge over other commercial edifices, backed by our proven expertise in delivering commercial services to these project, providing facilities to all kinds of commercial, professional, health care, educational and entertainment activities integrated in one place.

milestone  
**CITADEL**  
THE ELITE BUSINESS HUB

# SPECIFICATIONS

## BUILDING FEATURES

### Building Structures

- Earthquake resistance R.C.C. frame structure.

### Entrance Foyer

- Elegant entrance foyer with good ambience.

### Staircase

- Suitable granite / marble stone tread and risers at all floor levels.

### Elevation

- Energy efficient elevation.

### Parking

- Ample owner's parking at 3 level basement floor with well design parking layout.

### Toilets

- Common toilets on each floor.
- Allotted toilet in each office & showroom.
- Vitrified tile dado of 7' ht. & flooring in toilets.

### Flooring

- Elegant and exquisitely patterned granite / Italian flooring at ground floor entrance plaza.

### Terrace

- Water proofing on terrace with suitable finish china mosaic flooring.

### Elevators

- 3 high standard auto lift with optimum capacity of Kone/Schindler or equivalent make.

### CCTV

- CCTV camera in common area; passage area of all floors, basement parking, terrace, margin areas and foyer with connection at security.

### Power Backup

- Generator Power backup for Common Infrastructure facility as well as each shops having enough electrical point.

## INTERIOR UNIT FINISHES

### Wall Finish

- Internal wall finished with putti on mala plaster.

### Flooring

- Vitrified granamite in all offices & showrooms.

### Glass Facade with Glass Door

- Smoothly operatable glass doors in showrooms with glass facade.

### Toilets

- Attached toilets in all showrooms.





# GROUND FLOOR PLAN





# FIRST FLOOR PLAN

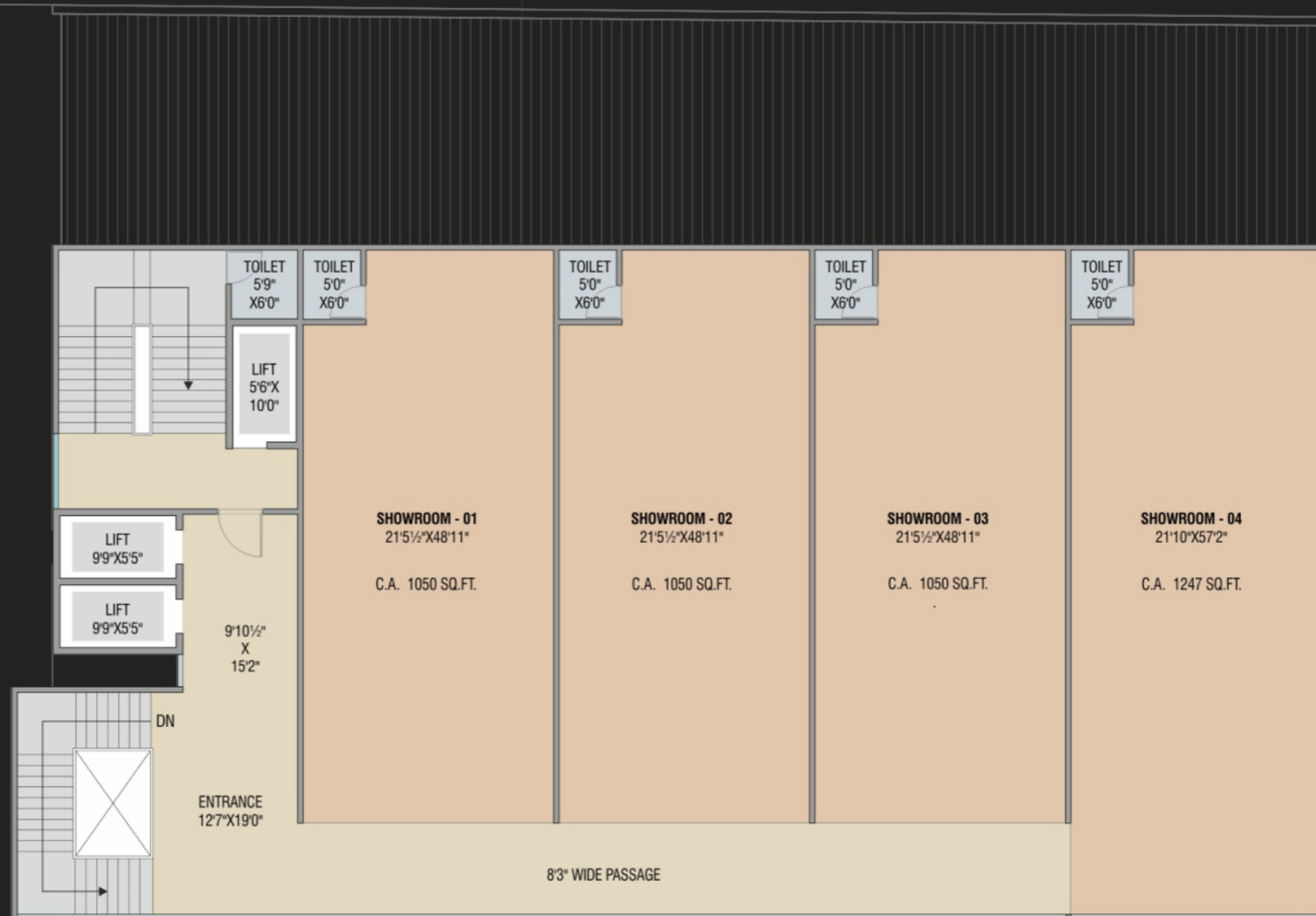



# TYPICAL FLOOR PLAN (2<sup>nd</sup> to 12<sup>th</sup> floor)

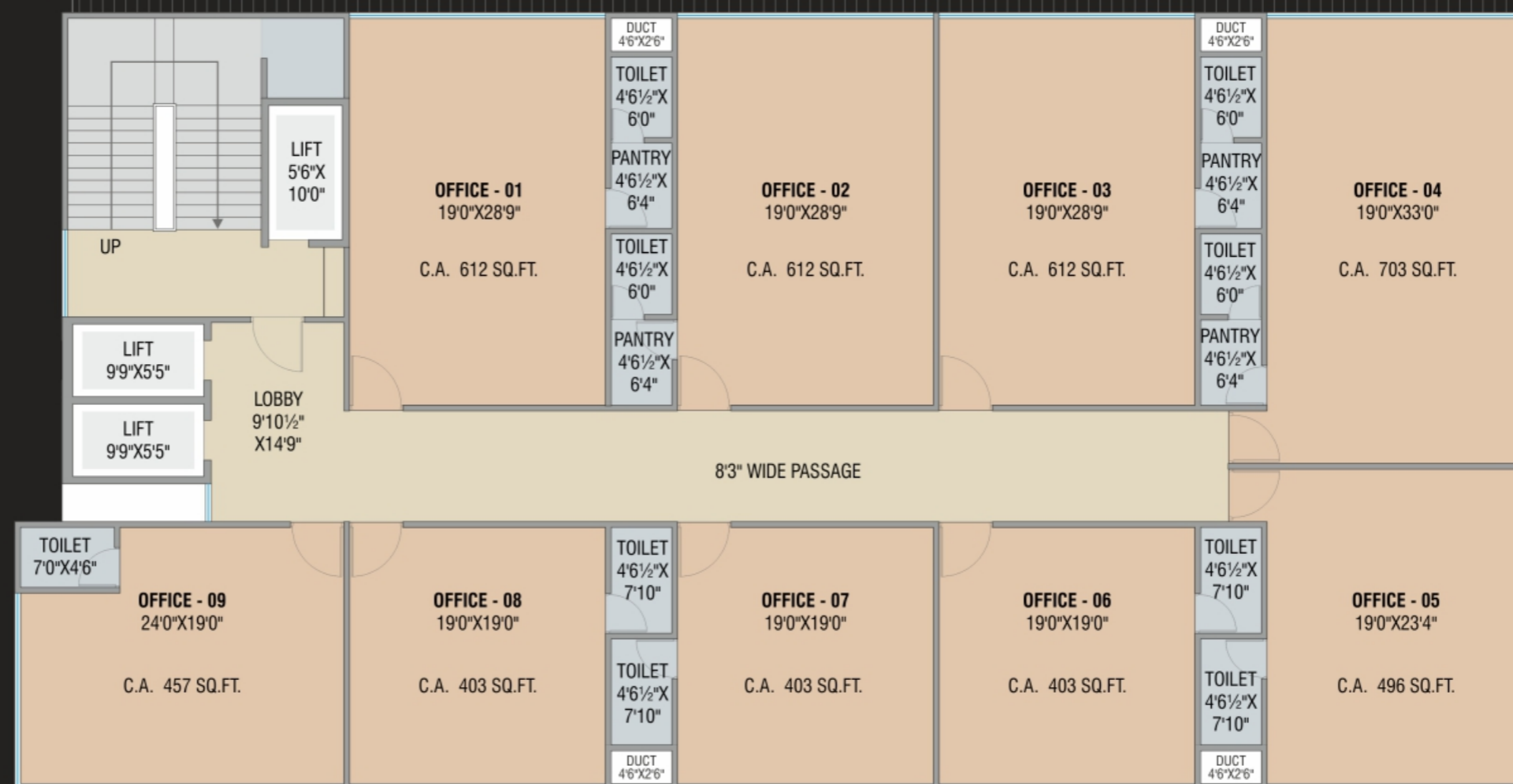

## KEY PLAN

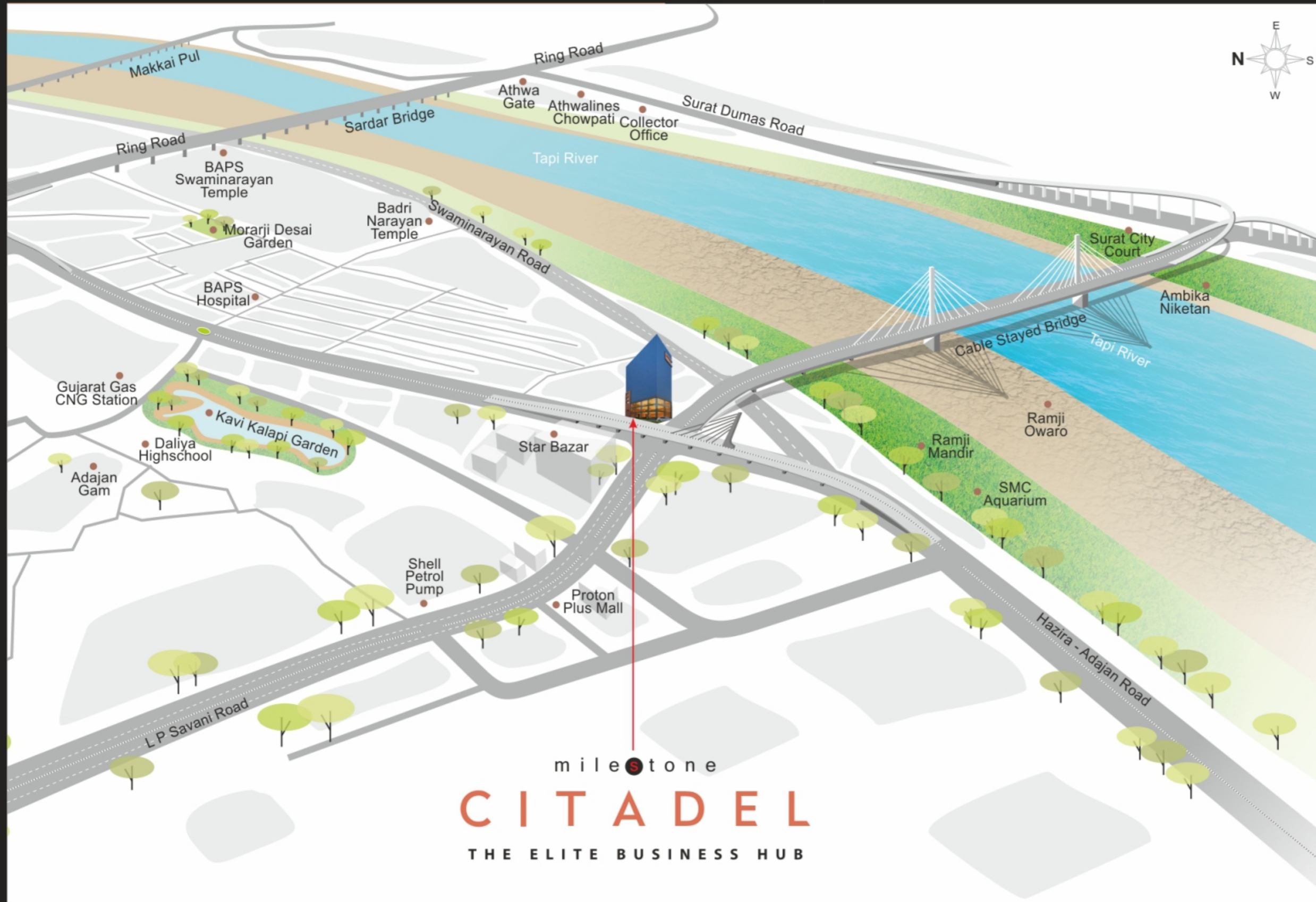

Bridge  
of Your  
Business

RERA No. : PR/GJ/SURAT/SURAT CITY/SUDA/CAA05508/060619

[www.gujrera.gujarat.gov.in](http://www.gujrera.gujarat.gov.in)

PROJECT BY

ARCHITECT

STRUCTURE

CONTACT

milestone  
REALTY

NIMISH CHOKSI  
ARCHITECTS

  
Bimal Jariwala & Associates  
CONSULTING STRUCTURAL ENGINEERS & DEVELOPER

Milestone Realty  
306-309, 3rd floor, Milestone Atlantis,  
Opp. Someshwara BRTS Junction,  
University Road, Vesu, Surat-395007  
(O.) 0261-2975888

+91 99243 31888

PROJECT BY

m i l e **s** t o n e  
REALTY

**Corporate Office:**

306 - 309, 3rd Floor, Milestone Atlantis,  
BRTS Someshwara Enclave Junction, University Road,  
Vesu, Surat - 395007

**Call-** 0261-2975888 | 99243 31888

**E-mail:** nekson.milestonerealtysurat@gmail.com

**Website:** www.milestonegroupsurat.com

